

# Efficient Retail Applications With Emerson's CO<sub>2</sub> Solutions

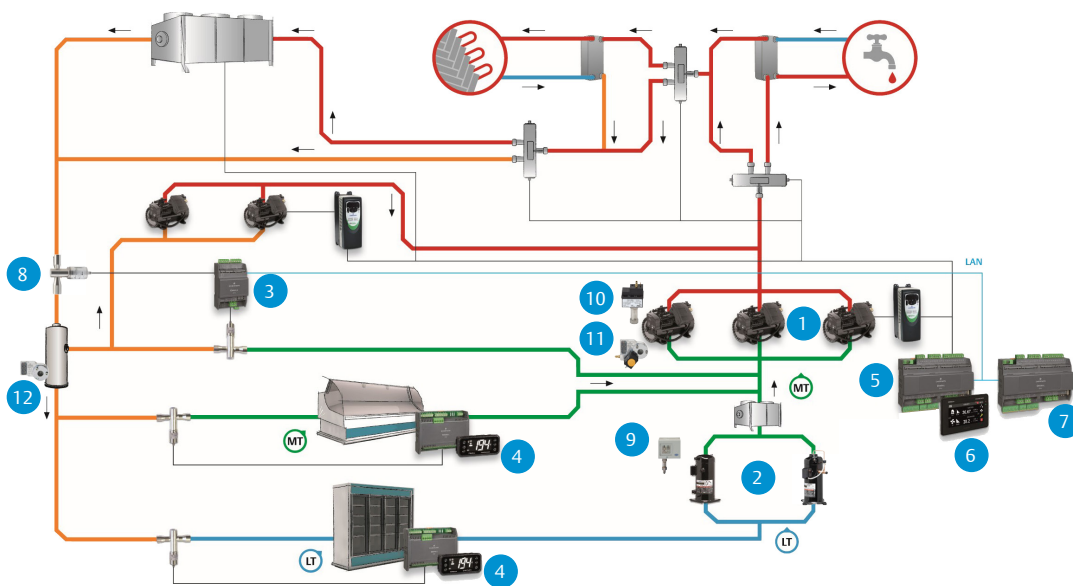

- 1 Copeland Stream CO<sub>2</sub>
- 2 Copeland Scroll CO<sub>2</sub>
- 3 Electronic Expansion Valve Driver
- 4 Cabinet Controller
- 5 Compressor Rack Controller
- 6 Touch Screen Display
- 7 Expansion Module
- 8 Electrical Control Valve
- 9 Adjustable Pressure Switch
- 10 Fixed Pressure Switch
- 11 Oil Level Management
- 12 Liquid Level Management

**LT** Low Temperature

**MT** Medium Temperature

*Transcritical booster solution with dual heat recovery, gas cooler bypass & parallel compression and de-superheater*

Increasing environmental concerns about the potential direct emissions from HFC-based refrigeration systems into the atmosphere have led to the revival of the refrigerant R744 in parts of the European refrigeration market. Regionally, this trend is reinforced by legislation and taxation schemes that favor the usage of R744.

## Offering Complete Solutions For CO<sub>2</sub> Booster And Cascade Systems

In comparison with HFC refrigerants, the specific properties of R744, such as high operating pressures, require changes in the design of the refrigeration system.

Emerson delivers comprehensive solutions for numerous refrigeration applications. Also for environmentally friendly CO<sub>2</sub> refrigeration applications, Emerson offers a unique advantage to customers with a complete CO<sub>2</sub> solution consisting of compressors with piston and scroll technologies, on-board compressor electronics, digital capacity modulation, flow controls and electronic controllers. It ensures high operational performance, safety and increased system uptime of CO<sub>2</sub> booster and hybrid systems.



## Scroll And Semi-Hermetic Reciprocating Piston Compressor Technology For CO<sub>2</sub>

The ZO range of Copeland Scroll™ compressors for subcritical applications and the semi-hermetic Copeland™ Stream compressors for subcritical and transcritical CO<sub>2</sub> applications have been developed specifically to leverage the characteristics of R744 refrigeration systems. Stream CO<sub>2</sub> compressors with high design pressures of 90/135 bar are dedicated to medium and low temperature CO<sub>2</sub> applications. ZO Scroll compressors with compactness and weight advantages are ideally suited for subcritical applications with CO<sub>2</sub> booster and hybrid systems. ZO Digital Scroll with digital capacity modulation provides a perfect match between capacity and load.



CO<sub>2</sub> compressor for transcritical & subcritical applications



Scroll compressor for subcritical applications



XM600 controller for display cases with EEV management



iProRACK for compressor rack control



XEV20D for flash gas valve and back pressure valve management

## Efficient System Management With High-Class Controls And Electronics

Emerson offers a wide range of valves and controls required for gas cooler, receiver and evaporator control in subcritical and transcritical applications. The product offering includes EX series high linear electrical flow control valves designed for a maximum operating pressure of 60 bar for subcritical applications and CV series valves designed for a maximum operating pressure of 120 bar for transcritical applications. The OM5 high pressure compressor oil regulator reduces the complexity of oil management system design.



Electronic OilLevel Management System OM5



High Pressure Flow Control Valves Series CV



Electronic Oil Level Monitoring System - OW5

## Benefits Of Emerson CO<sub>2</sub> Solution:

- Complete solution for CO<sub>2</sub> booster and cascade systems with compressors, flow controls and electronic controllers
- Consistently high design pressures across compressors and controls to ensure high operational safety and increased system uptime
- Stream CO<sub>2</sub> is equipped with modular CoreSense™ Technology that offers advanced compressor protection, diagnostics, communication and power consumption monitoring
- Advanced system insights from CoreSense technology communicating through Emerson control and monitoring devices: validating system performance, minimizing maintenance costs and extending system lifetime
- Emerson controllers manage the refrigeration systems, operating point to the optimum efficiency level
- Easy to install and adjust controllers and evaporator side controllers

For more details, see [climate.emerson.com/en-gb](http://climate.emerson.com/en-gb)

Emerson Commercial & Residential Solutions

Emerson Climate Technologies GmbH - European Headquarters - Pascalstrasse 65 - 52076 Aachen, Germany

Tel. +49 (0) 2408 929 0 - Fax: +49 (0) 2408 929 570 - Internet: [climate.emerson.com/en-gb](http://climate.emerson.com/en-gb)

The Emerson logo is a trademark and service mark of Emerson Electric Co. Emerson Climate Technologies Inc. is a subsidiary of Emerson Electric Co. Copeland, Copeland Scroll, Alco Controls and Dixell are registered trademarks of Emerson Climate Technologies Inc.. All other trademarks are property of their respective owners. Emerson Climate Technologies GmbH shall not be liable for errors in the stated capacities, dimensions, etc., as well as typographic errors. Products, specifications, designs and technical data contained in this document are subject to modification by us without prior notice. Illustrations are not binding.

© 2018 Emerson Climate Technologies, Inc.

EMERSON. CONSIDER IT SOLVED.™